

Issue 25

In this issue, attach the Lower Control Arms and Rear Stabiliser Bar to the Floor Panel assembled up to Issue 22, and assemble the Rear Shock Absorber Brackets.



Assemble the Rear Axle (2)

※ In this guide "Left" or "(L)", and "Right" or "(R)", refer to the direction as viewed from the driver's seat.

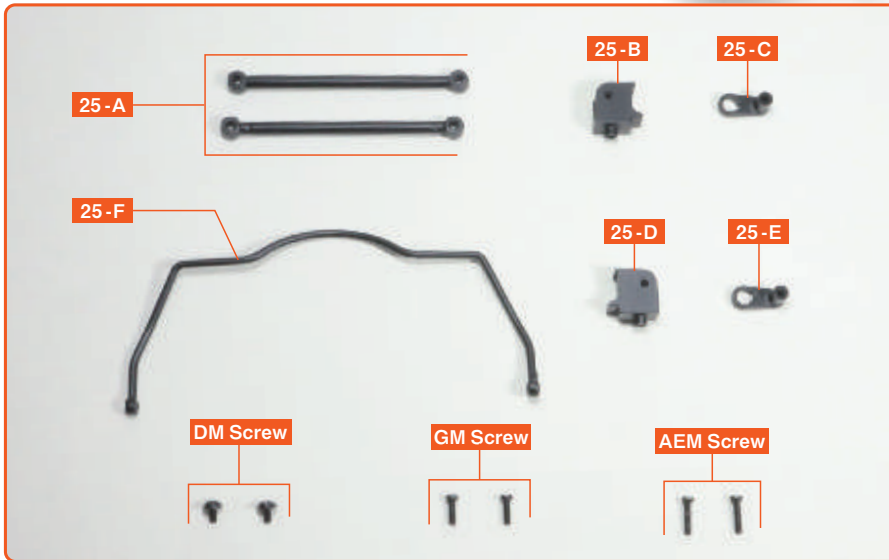

25-A Lower Control Arm × 2

25-B Rear Shock Absorber Bracket L (1)

25-C Rear Shock Absorber Bracket L (2)

25-D Rear Shock Absorber Bracket R (1)

25-E Rear Shock Absorber Bracket R (2)

25-F Rear Stabiliser Bar

DM Screw (2.0×4×5mm) ×2+Spare

GM Screw (2.0×6mm) ×2+Spare

AEM Screw (2.0×8mm) ×2+Spare

View the follow-along video



※ Due to the model's design, the shapes of some parts may differ from those of the real vehicle.

step 1 Install the Lower Control Arm

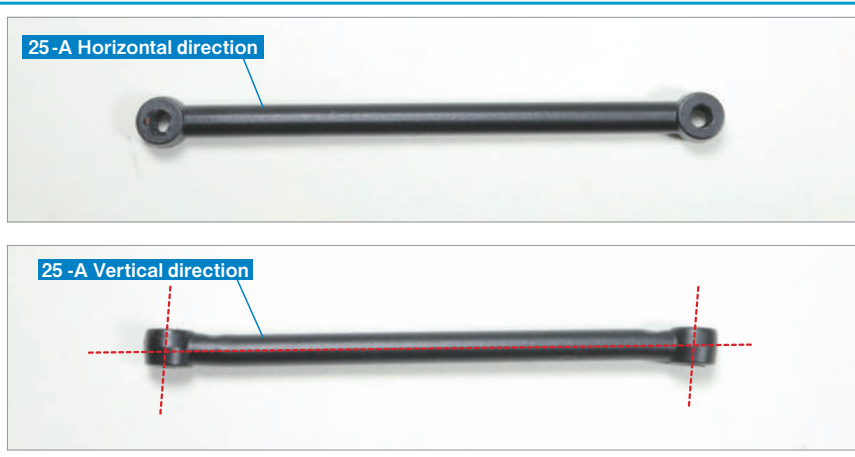

Before assembly, check the shape of **Lower Control Arm 25-A**. The screw holes at both ends of the two **25-A** are angled.

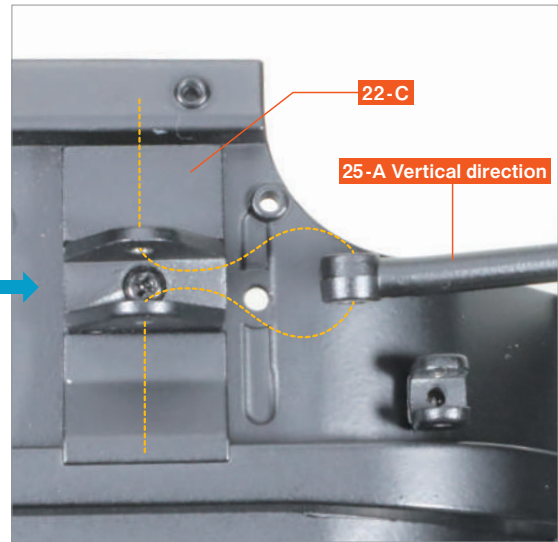
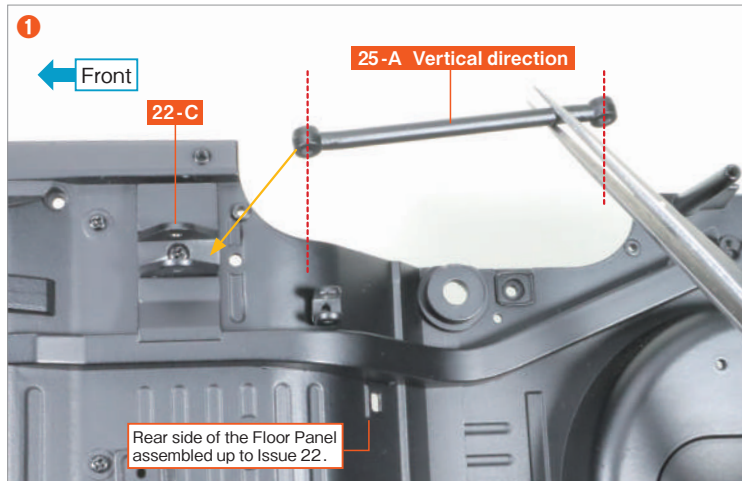

Prepare the Floor Panel assembled up to Issue 22. Insert the ends of **25-A** between the **Lower Control Arm Brackets 22-C**, aligning with the screw holes on **22-C**.

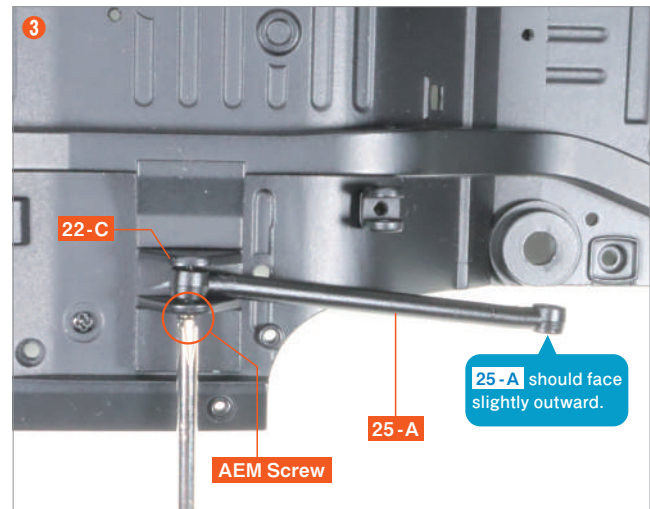
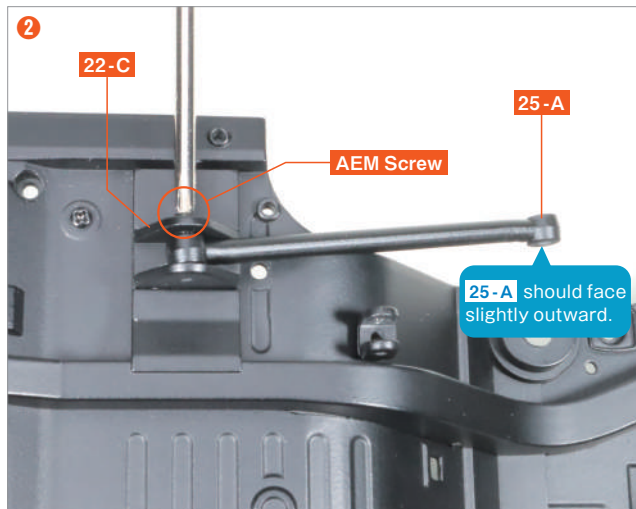

Secure **25-A** by tightening **AEM Screws** into the screw holes of **22-C** from the outside of the Floor Panel. If the screws are difficult to tighten, pre-thread the holes by fitting **AEM Screws** into **22-C** before inserting **25-A**.

Insert the other **25-A** into the remaining **22-C** on the opposite side, align the screw holes, and secure from the outside of the Floor Panel with **AEM Screws**. If the screws are difficult to tighten, pre-thread the holes as described in **2**.

Step complete

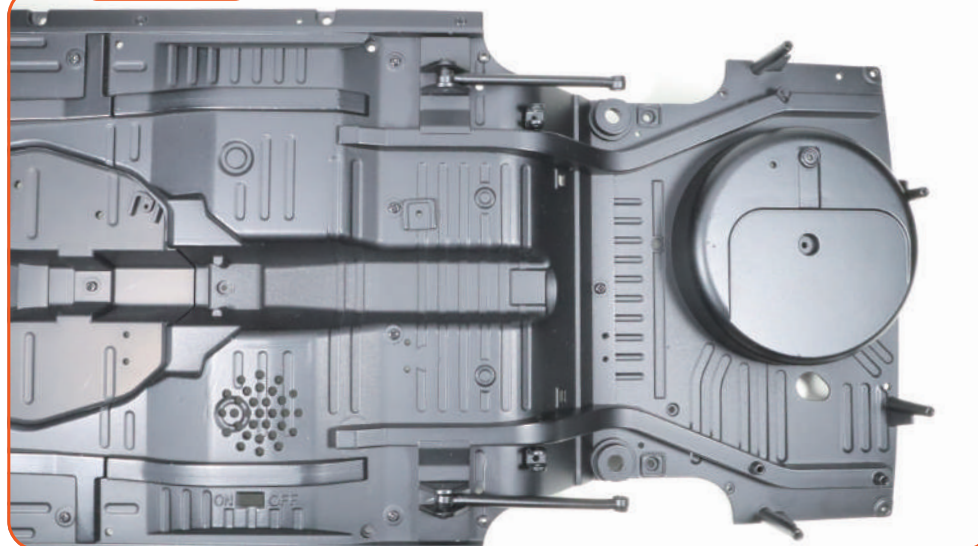

25-A will be connected to the Rear Axle in a later issue, so a small amount of movement is acceptable.

step 2 Assemble the Rear Shock Absorber Bracket

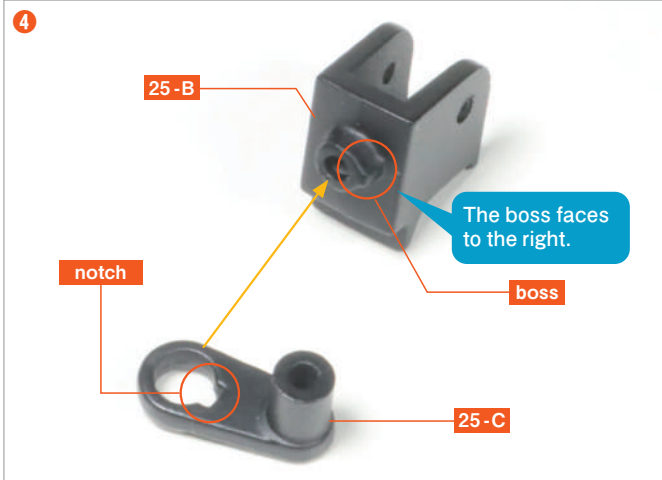

Align the notch on **Rear Shock Absorber Bracket L (2) 25-C** with the boss on **Rear Shock Absorber Bracket L (1) 25-B**, then press into place.



Secure with a **DM Screw**.

[Left-hand side] Rear Shock Absorber Bracket.

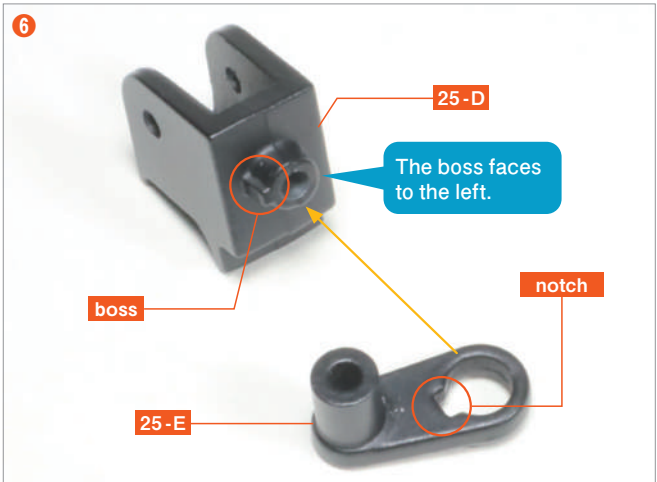
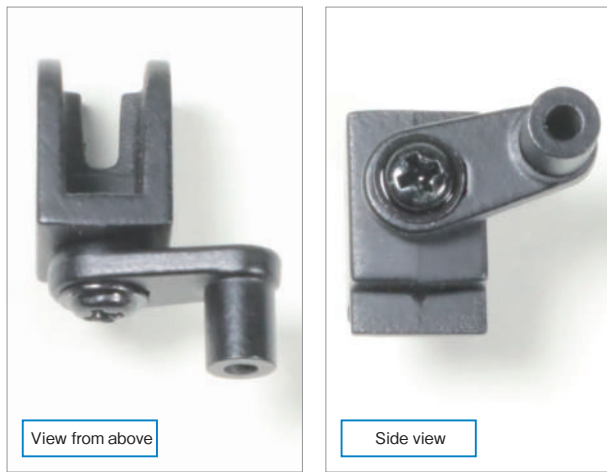

Align the notch of **Rear Shock Absorber Bracket R (2) 25-E** with the boss on **Rear Shock Absorber Bracket R (1) 25-D**, then fit the parts together.



Secure with a **DM Screw**.

[Right-hand side] Rear Shock Absorber Bracket.



step 3 Install the rear stabiliser bar

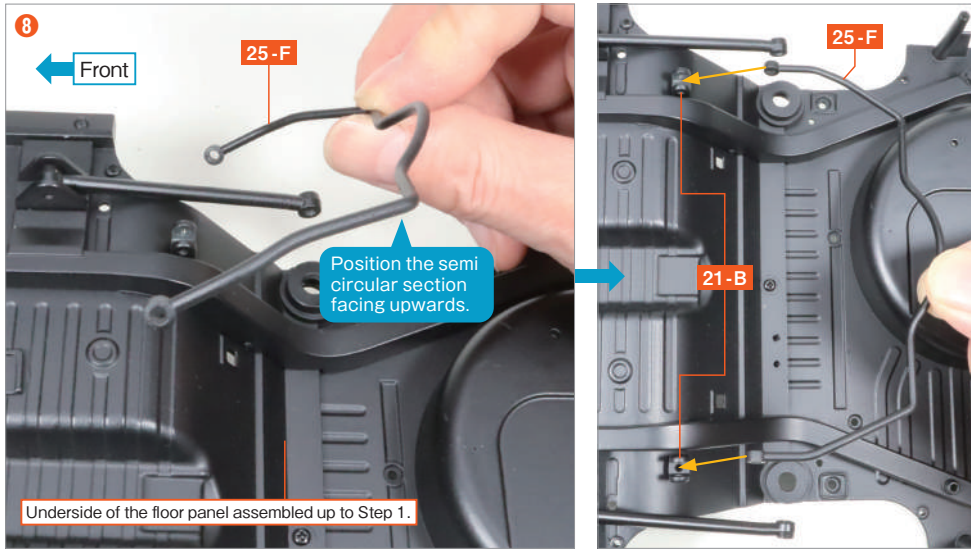

Ensure the correct orientation, then insert both ends of **Rear Stabiliser Bar 25-F** between **Rear Stabiliser Bar Brackets 21-B**.

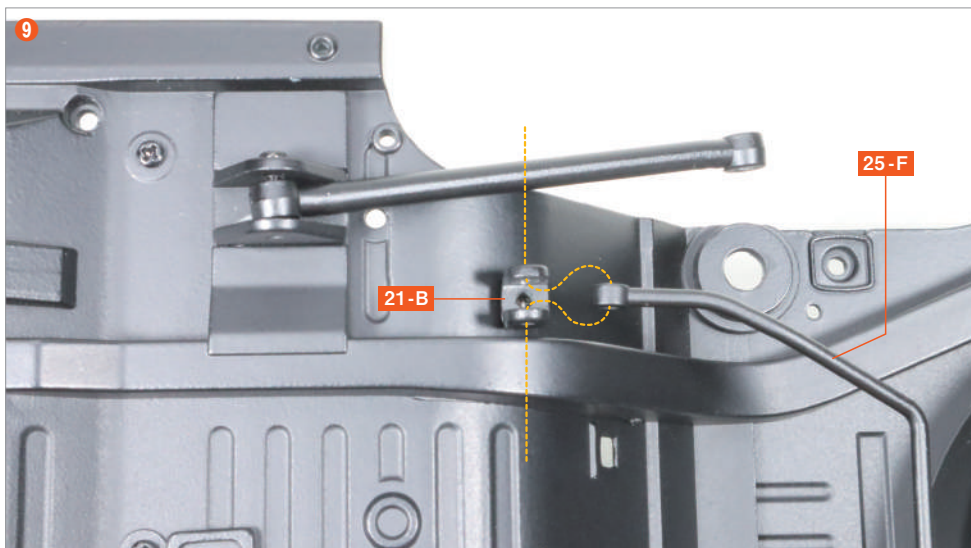

Align the screw holes of **21-B** and **25-F**.

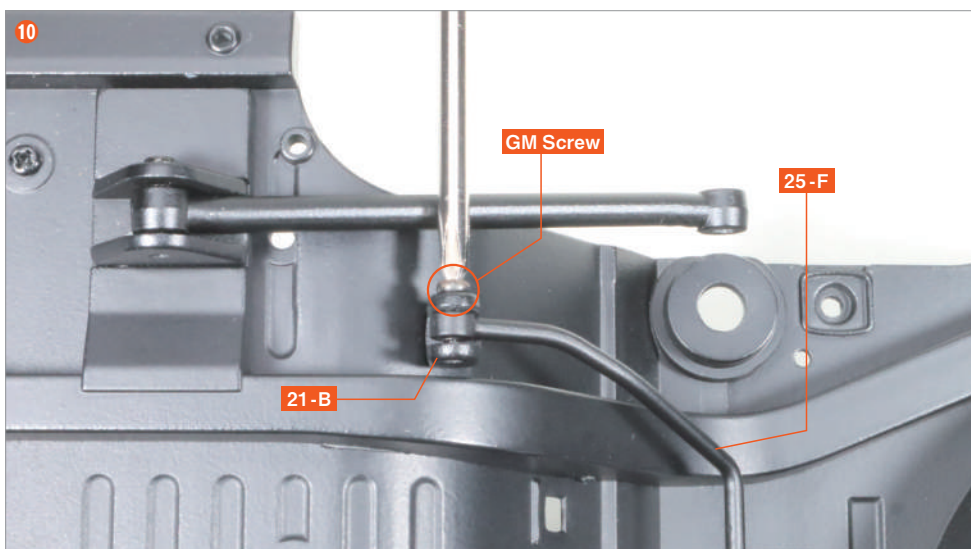

Tighten a **GM Screw** into the threaded hole of **21-B** from the outside of the floor panel to secure **25-F**.

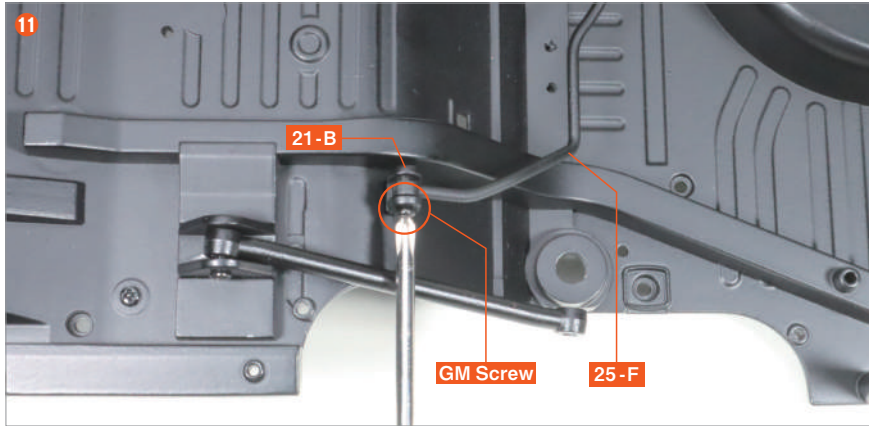

Insert the other end of **25-F** into the opposite **21-B**, align the screw holes, and secure it with a **GM screw** from the outside of the floor panel.

Ensure that **25-A** and **25-F** move freely back and forth.

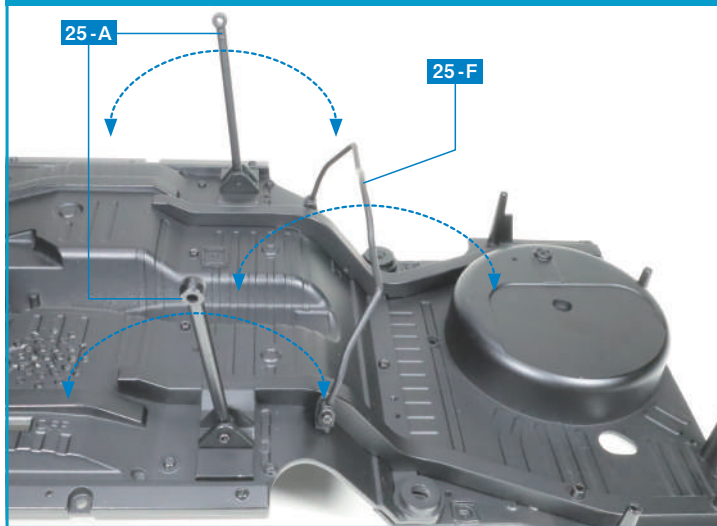

Step complete

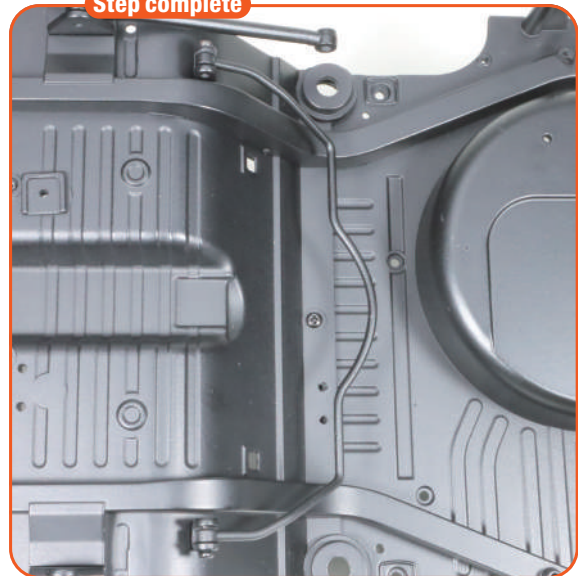

Complete

The assembly for Issue 25 is complete. In Issue 26, attach the rear shock absorber bracket assembled in this issue to the lower side of the rear axle housing, then combine it with the upper side of the rear axle housing.

